

Available Building for Sublease



Reynosa



27,647 m²
297,590 sq.ft.



Noma

General information

Description:	Industrial Building for Sublease
Location:	Parque Industrial Villa Florida (Reynosa, Tamps.)
Total Building:	27,647 m ² (297,590 sq.ft.)
Available Area:	27,647 m ² (297,590 sq.ft.)
Offices Area:	5,200 m ² (55,331 sq.ft.)
Clear Height:	7.31 mts (24 ft)
Dimentions:	122 m X 213 m (400 ft. X 699 ft.)
Docks Doors:	19 Docks
Ramps:	2 Ramp
Floor Thickness:	15cm (6 Inches)
Roof System:	Standing Seam Metal Roof
Substation:	2 x 2,500 kva
Fire Protection:	EFSR Sprinklers + Cabinets 318,000 gallon tank
HVAC:	800 Tons.
Parking Lot:	600 Cars
Year Built:	2003

Location map

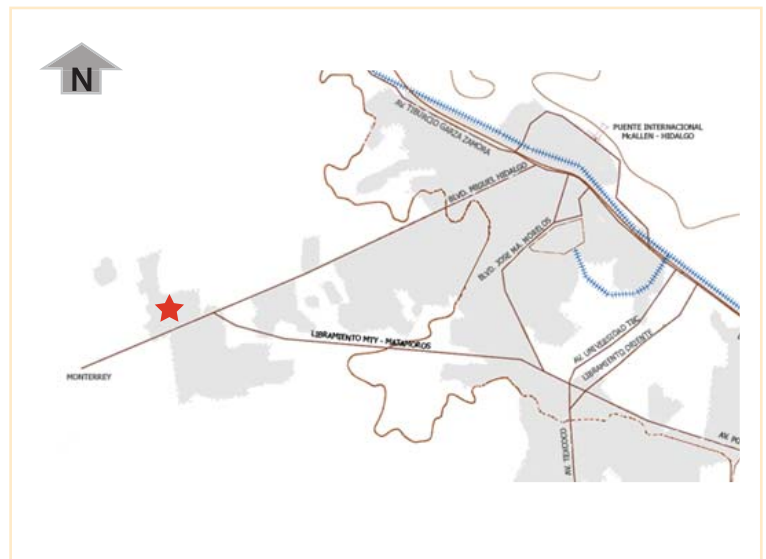

General layout

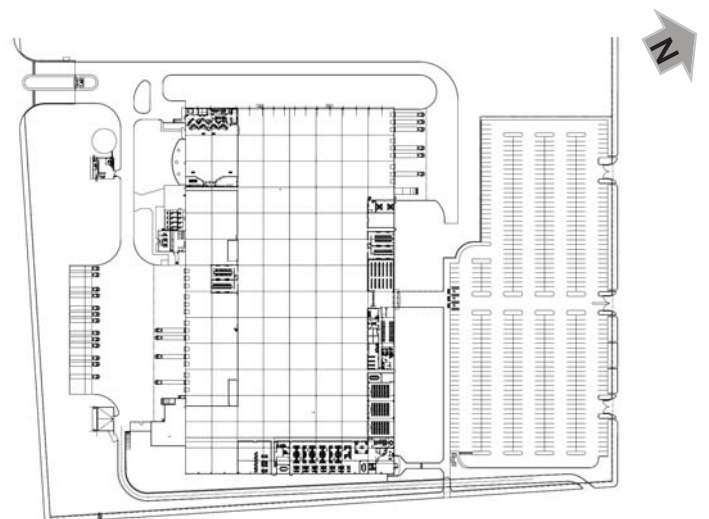

CONTACT:

■ Miguel Cavazos
miguel.cavazos@citiuscapital.com
mobile:

mex +52 (181)8254.6421
u.s. +1(956) 607.6942

■ Dario Villarreal
dario.villarreal@citiuscapital.com
mobile:

mex +52 (181)8309.1917
u.s. +1(956) 607.6952

■ office:
Tel. +52 (81) 8115.3275
Diaz Ordaz #3057 Euro Plaza / Suite 25
Col. Santa María. Monterrey, N.L. México

*"Building in
great industrial
location"*